

NOTE: Chamfer all corners 0.030 - 45°

HARDWARE:

1. Spring L=1.500, diam. 0.370, wire diam. 0.055
2. Set Screw #8-32 3/16"

Tap Follower		
Body Steel	By TUBALCAIN mrpete222/youtube	Sheet #1 of 3
		-toly 1-8-2017

View AA

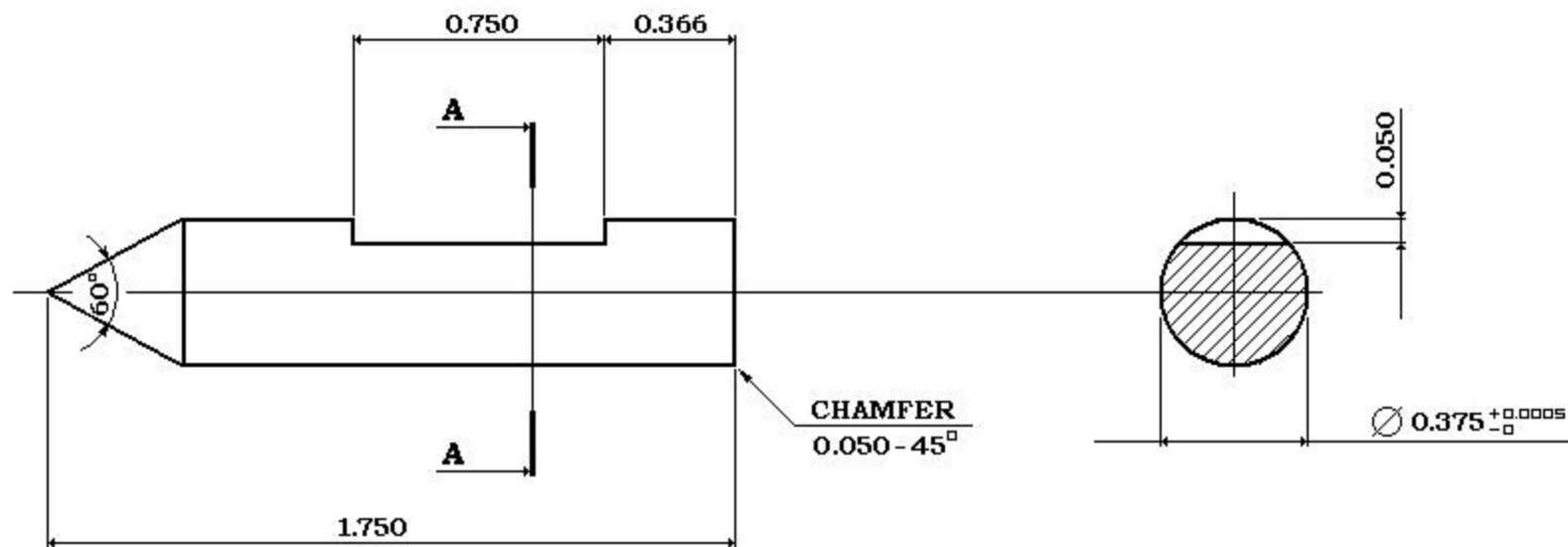

NOTE: Harden and Temper (per your alloy heat requirements)

Tap Follower		
Pointer, opt. 1 Tool Steel	By TUBALCAIN mrpete222/youtube	Sheet #2 of 3
		-toly 1-8-2017

View AA

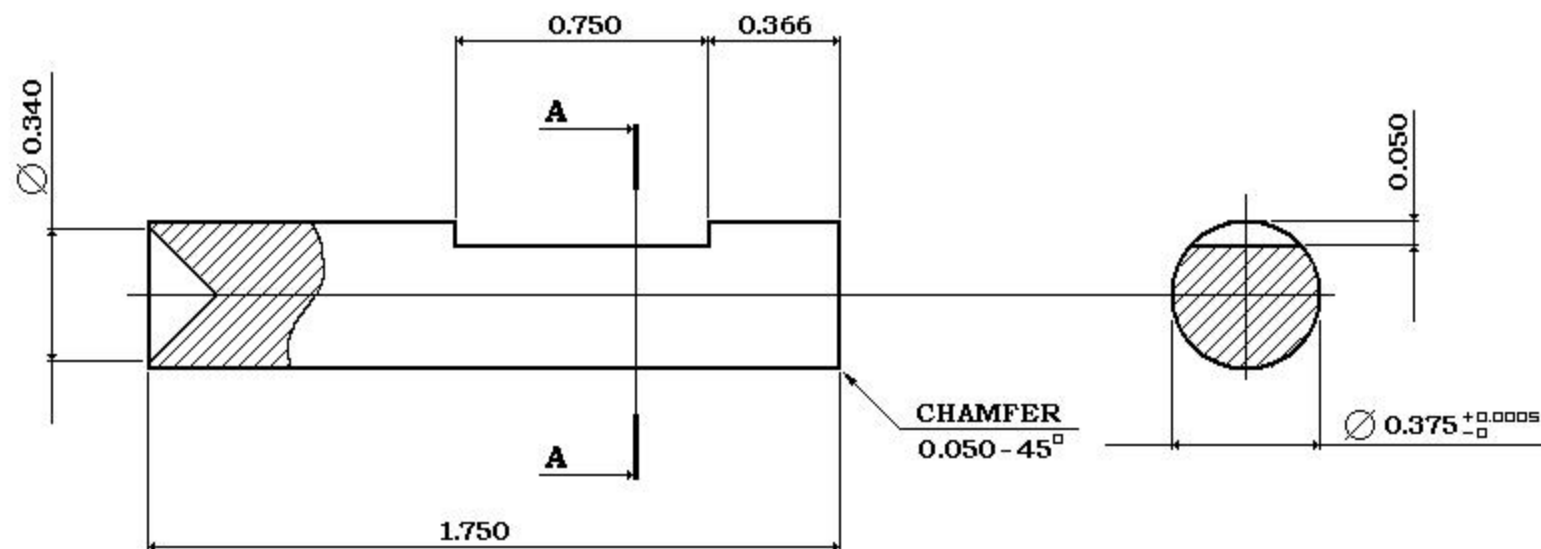

NOTES: 1. Internal Taper 90°

2. Harden and Temper (per your alloy heat requirements)

Tap Follower

Pointer, opt. 2
Tool Steel

By TUBALCAIN
mrpete222/youtube

Sheet #3 of 3
-toly 1-8-2017